

ASTRO-PHYSICS

2" ADVANCED CONVERTIBLE BARLOW (BARADV)

(Note: Objects are not to scale for purpose of illustration.)

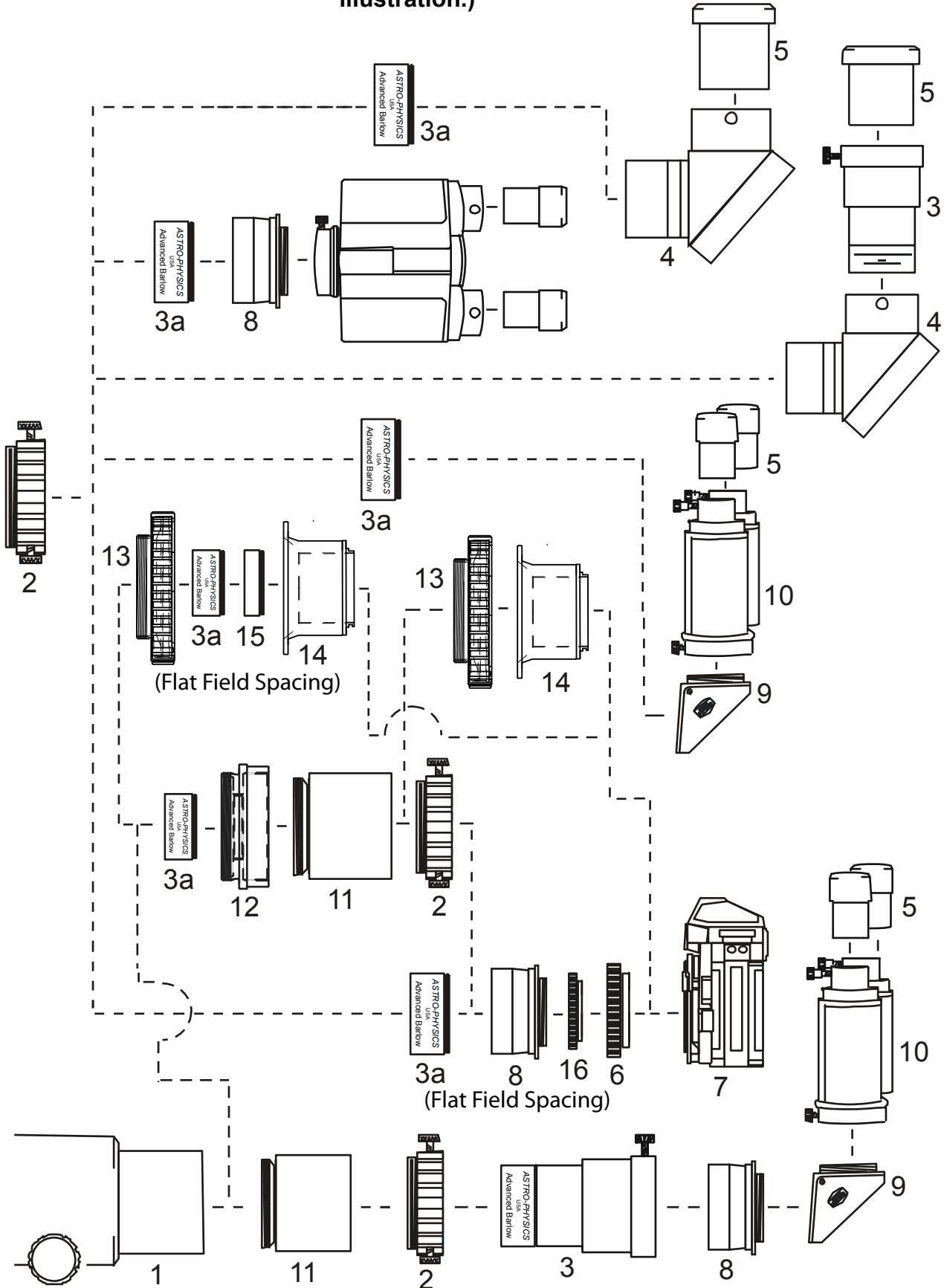

ASTRO-PHYSICS

2" ADVANCED CONVERTIBLE BARLOW (BARADV)

1. 2.7" Focuser (27FOC3E) - supplied with AP refractors and some Ritchey-Chretien
2. 2" Adapter with 3 large thumbscrews (ADA2003) - ADA2003 supplied with AP refractors
3. 2" Advanced Convertible Barlow (BARADV) - complete unit
- 3a. 2" Advanced Convertible Barlow (BARADV) - without 2" Extension (ADA202)
- 3b. 2" Extension - Length 1.75" (ADA202) - included with Advanced Barlow (BARADV)
4. 2" MaxBright Diagonal (PMDMAX)
5. Eyepieces (only 1.25" eyepieces will work in the BPMARKVS) - Note: some eyepieces may not come to focus
6. Camera T-Ring for 35 mm Camera
7. 35 mm Camera Body
8. 2"/T-2 Tapered Nosepiece (AP16T)
9. Mirror Diagonal from Baader Planetarium (BP1A) - included with Mark V Binocular Viewer
10. Mark V Binocular Viewer from Baader Planetarium (BPMARKVS) - shown with Quick Change Ring T-2 (BP7) attached
11. Thread-On Extension for 2.7" Focuser (A1008-A) - length 2.5" - additional Thread-On Extensions are available in different lengths
12. Threaded 2.7" Extension with Internal T-Thread (A3511)
13. 2.7" to 6x7 Outer Bayonet Adapter (ADA2767)
14. SLR Camera Adapter with Large 1.875" Diameter Canon EOS Bayonet (67RLEOS)
15. 2" Barrel Extension w/ 48 mm Threads (A3703)
16. Baader T-2 Extension Tube, 7.5 mm length (BP25C)